

Swivel castor 530 10x34 50 P

Furniture Castors Series 530 ST - Wheel P

 -20 °C - +60 °C

swivels easily

wear resistant

shock proof

floor protective

weather proof

Wheel

Casted high quality nylon wheel black

High quality nylon housing - black

Swivel bearing with combined
plain-ball bearing

Wheel brake - glass fibre reinforced

Wheel axle revited

Swivel castor	Wheel-Ø A x width B mm: 52x8+8
Load Capacity kg:	40
Load capacity tested according to EN 12530 and EN 12527	
Overall height H mm:	62
Stern mm:	10x34
Swivel radius SR mm:	52
Wheel bearing:	Nylon plain bearing

Advantages

- ✓ easy running on smooth floors
- ✓ impact proof
- ✓ high abrasion resistance
- ✓ easy to clean
- ✓ high chemical resistance

©Copyright 2024 Rollenbau GmbH, www.rollenbau.at 20.05.2024

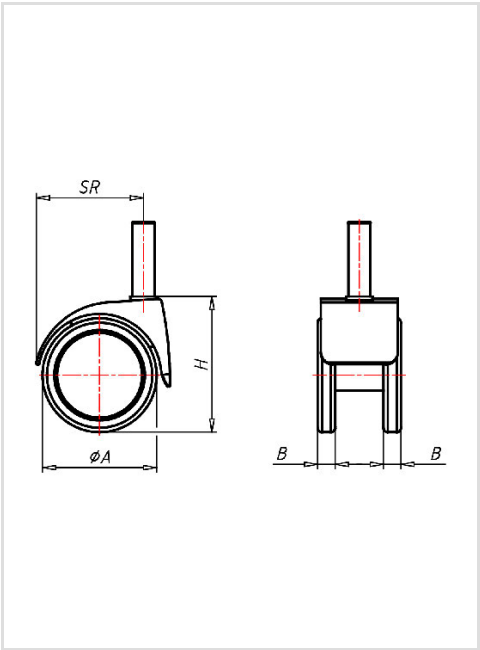

Applications

- Health-Professionals